

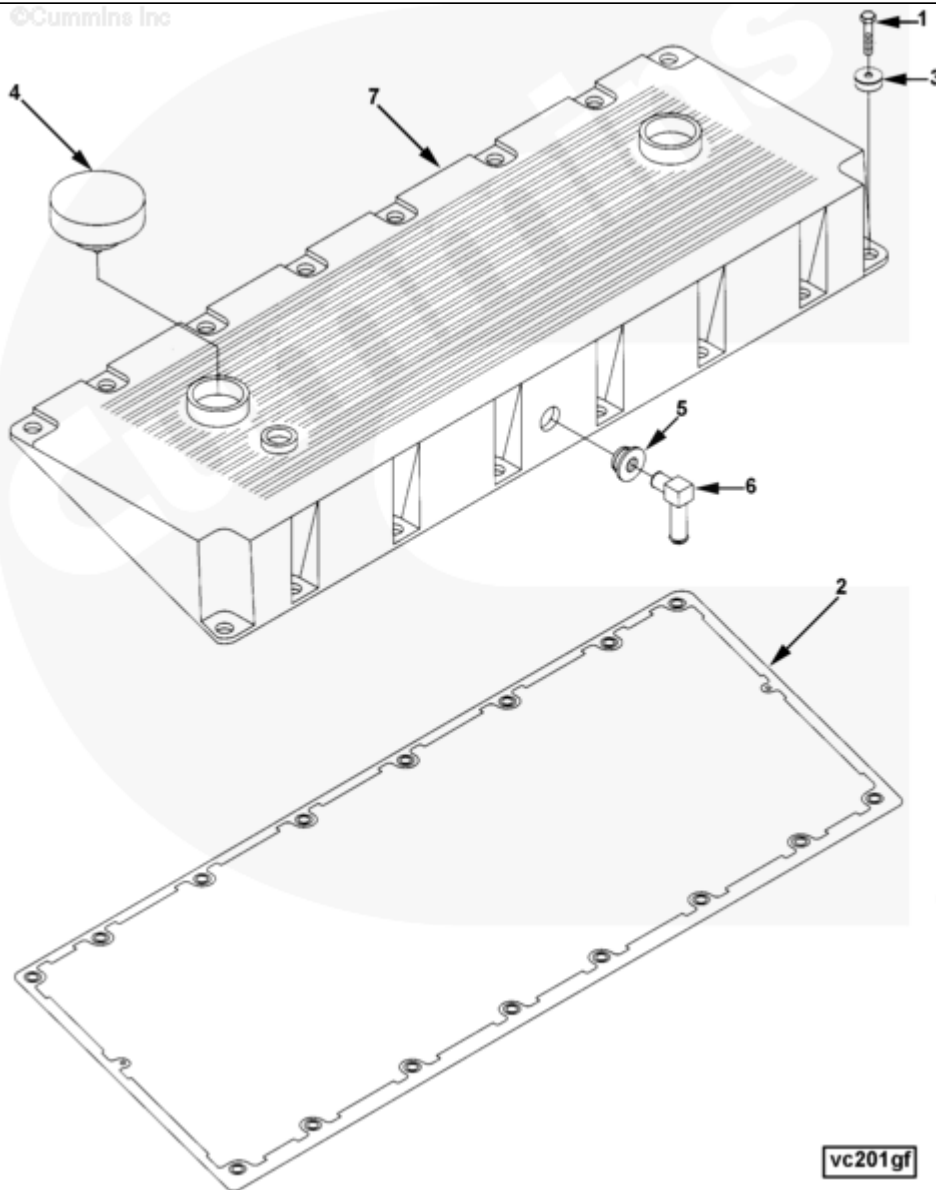

# Parts Catalog - Option Detail

Electronic Parts Catalog - Option Detail				
Option	Group	Graphic	Film Card	Date
VC2065-10	03.01.1	vc201gf	II	12-JUN-08
<b>Engines</b>	ISM CM570, ISM CM570/870, ISM CM875, ISM CM876, ISM CM876 E, ISM11 CM876 M103, ISM11 CM876 SN, M11 CELECT, M11 CELECT PLUS, M11 MECHANICAL, QSM11 CM570, QSM11 CM876			



[SMALL](#) | [MEDIUM](#) | [LARGE](#)

Cart	Ref No	Part Number	Part Description	Required	Remarks
<a href="#">View My Cart</a>					

		VC2065-10	Valve Cover		
					Valve Cover
					Breather Mtg Arrangement:
					Internal
					Breather Vent Location: Side
					Material: Plastic
					Oil Fill Location: Front
					Engine Position: Vertical
					Standard
					Straight Thd O-Ring Port Dia:
					None
					Valve Cover Pitch (Deg): 23
					Breather Type:
					Baffled/Screened
<input type="checkbox"/>	1	<a href="#">3899757</a>	Hexagon Head Cap Screw	16	M8 x 1.25 x 40
<input type="checkbox"/>	2	<a href="#">3883220</a>	Rocker Lever Cover Gasket	1	
<input type="checkbox"/>	3	<a href="#">3899798</a>	Noise Isolator	16	
<input type="checkbox"/>		<a href="#">4963809</a>	Cover , Rocker Lever Top Level Assembly Front	1	
<input type="checkbox"/>	4	<a href="#">4071224</a>	Filler Cap	1	
<input type="checkbox"/>	5	<a href="#">3042401</a>	Grommet Seal	1	
<input type="checkbox"/>	6	<a href="#">3047134</a>	Breather Tube	1	
	7	<a href="#">4961286</a>	Rocker Lever Cover	1	